



FF-700/600

# Electric Bike Assembly

This document shows how to safely assembly your new Fantom Electric Bike. Please follow it carefully.

- Electric bike is flat packed using the SKD (Semi Knock Down) 85% system. This means that the front wheel needs to be assembled to the bike front fork, while handlebar set to be bound to frame. Bike seat needs to be set to desired height and pedals mounted.
- Inside the carton, we will arrange the necessary inner protection pads to ensure the bike is kept safely in a perfect position, after long transportation and frequent loading and off-loading.
- Packaging size: 150cm x 75cm x 25 cm or 60'' x 30'' x 10''.

### Step I

- ✓ Pull the bike and all its parts out of the box.
- ✓ CAREFUL no to damage or scratch the bike and take extra care of the wires and other parts already mounted onto bike. Check that all the parts are there.

### Step II

#### ➤ Quick-release

- ✓ How to put on the springs?  
Put the narrower end to the inside (first). The springs fitted in this way guarantee trouble-free use of the quick-release device.
- ✓ How to put the lever on?  
For aesthetic and practical reasons, it is best to fasten on the same side as the rear drive.

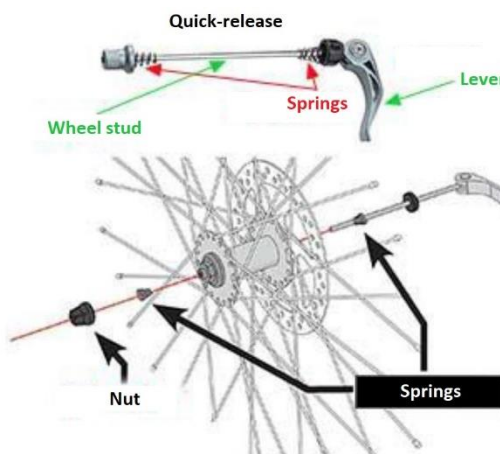

- ✓ The front wheel is removed, so after opening the carton, remove the protective film from it and mount it on the front fork.
- ✓ Insert the wheel stud through the wheel, tighten the nut on the left so that the quick-release closes with the appropriate resistance.

### Step III

#### ➤ Handlebar

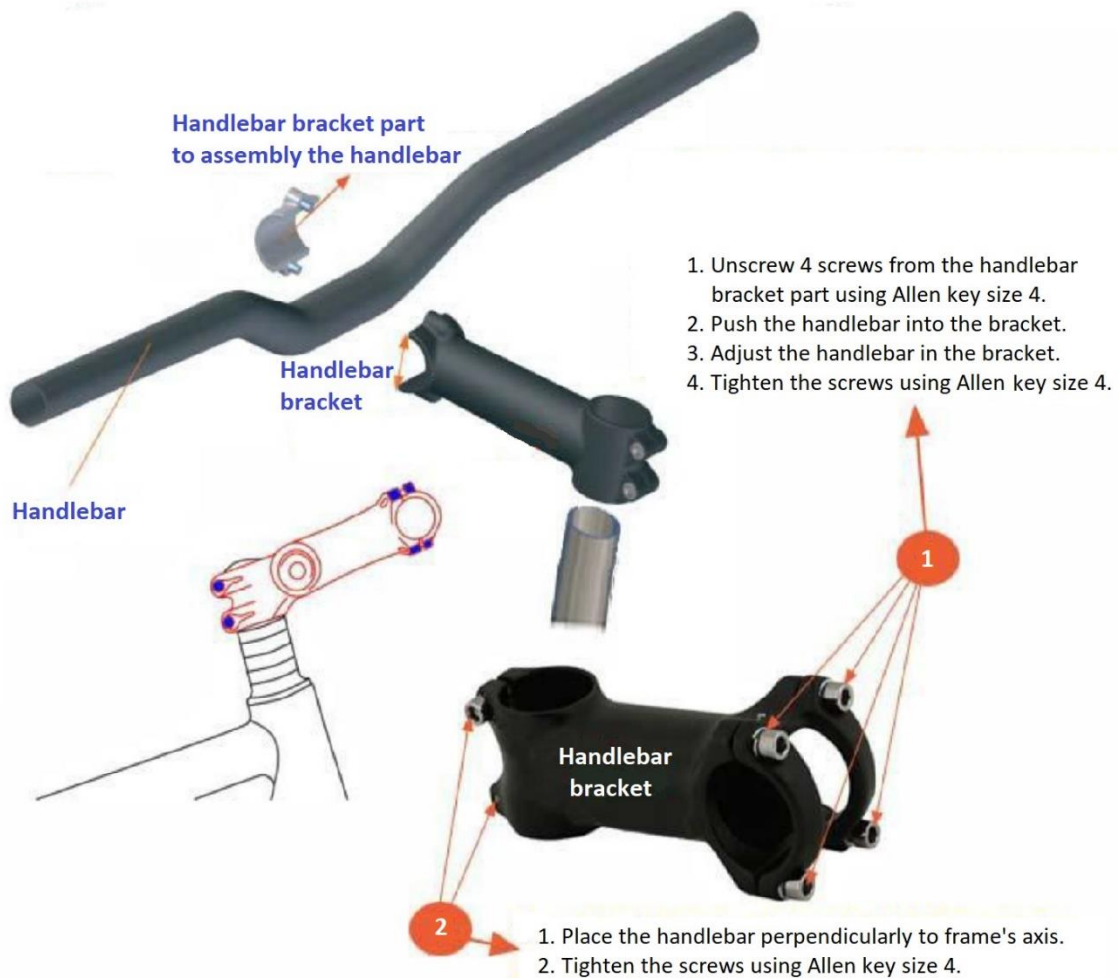

### Step IV

#### ➤ Seat

- ✓ Loosen the quick-release nut on the bicycle frame and insert the seat post.
  - ✓ Tighten the nuts on the seat post clamp so that the quick-release tightens with the appropriate resistance.
  - ✓ The final adjustment of the saddle position is carried out by moving the saddle in the dimple forward or backward.
- ▲ The seat post must be inserted into the frame so that the safety indicator on the seat post is not visible (check diagram on the next page).

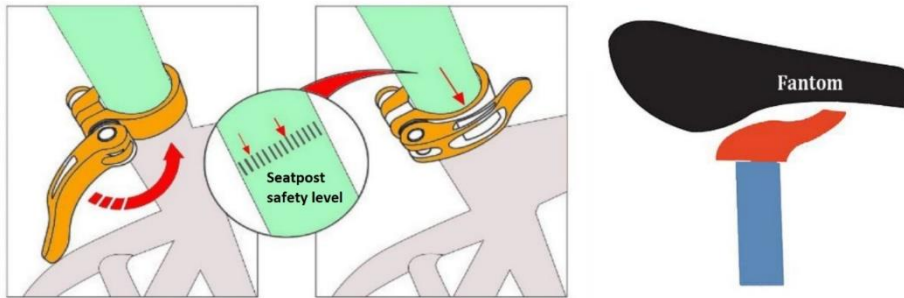

## Step V

### ➤ Pedals

- ✓ Manually tighten the pedal marked with the letter "R" on the right side in the clockwise direction then tighten it with a wrench No. 15 with a force of 34 N m.
- ✓ Manually tighten the pedal marked with the letter "L" on the left side in the counterclockwise direction then tighten it with a wrench No. 15 with a force of 34 N m.

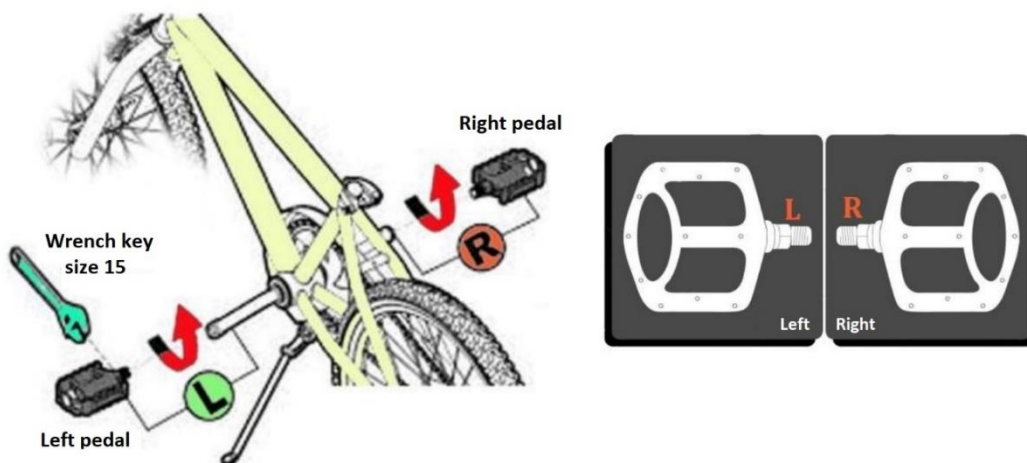

## Step VI

### ➤ Brakes



- ✓ By default, the brakes should be set during installation in factory, nevertheless, they tend to deregulate, therefore, they require checking after the first test drive.
- ✓ Adjustment should also take place during use of bicycle if necessary. If you require additional consultation, please contact your local professional bicycle point.